



REPLACES

Brake Shoes & Linings

- 9N2019**
\$83.40
Brake shoe set, 4 shoes with bonded lining. Priced and boxed per set of 4. For tractors 9N, 2N, (1939 thru 1947). 
- 8N2200B**
\$53.48
Bonded brake shoes. Priced and boxed per set of 4. For tractors 8N, NAA. 
- NCA2218B**
\$23.90
Shoe, w/ lining. Priced each, shipped 2 shoes per box. For tractors 600, 700, 800, 900, 2000, 4000, (to 1964). 
- 8N2007A**
Call for Price
Brake lining, set of 4, w/rivets. 2" W x 12-5/8" L. For 8N. 
- C5NN2284F**
\$28.52
Brake lining, set of 4, w/rivets. 2" W x 15- 1/2" L. For tractors 9N, 2N.
Models 12-1966 & later
- D9NN2218AA**
\$22.37
Shoe, with/lining. Priced each, shipped 2 shoes per box. For tractors 2000, 3000, (except 3500), 4110, (12-1996 & up); 2600, 3600. Replaces C5NN2218F.
- C7NN2218A**
\$25.41
Shoe, w/lining: similar to shoe above except 2" wide. Priced each, shipped 2 shoes per box. For 3500. May use as HD replacement for D9NN2218AA. 

REPLACES

Brake Discs & Parts For Wet Brakes

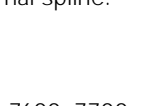
- C5NN2A097B**
\$28.22
Friction disc, 8" dia., 22 tooth internal spline. 
- 1965-1975
Tractors 3550, 4000, 4200, Industrials 4500
- 1975-1980
Tractors 3900, 4100, 4600, Industrials 420, 515, 532, 535, 340, 445, 540, 545, 550, 555, 650, 750, 5500, 5550, 6500, 7500,
- 1981 & up
Tractors 3910, 4110, 4610, Industrials 555
- C5NN2N315B**
\$14.15
Intermediate steel disc, 8" diameter. 
- 1965-1975
Tractors 3550, 4000, 4200, Industrials 4500
- 1975-1980
Tractors 3550, 4000, 4200, Industrials 4500
- 1975-1980
Tractors 3900, 4100, 4600, Industrials 420, 515, 532, 535, 340, 445, 540, 545, 550, 555, 650, 750, 5500, 5550, 6500, 7500
- 1981 & up
Tractors 3910, 4110, 4610, Industrials 555
- C7NN2A097B**
\$38.36
Friction disc 9" dia., 22 tooth internal spline. 
- 1965-1975
Tractors 5100, 5200, 7100, 7200
- 1975-1980
Tractors 5600, 5700, 6600, 6700, 7600, 7700
- 1981 & up
Tractors 5610, 6610, 6710, 7610, 7710, 7910

C5NN2N315A Intermediate steel disc, 9" diameter.
\$14.15
 1965-1975
 Tractors 5100, 5200, 7100, 7200
 1975-1980
 Tractors 5600, 5700, 6600, 6700, 7600, 7700
 1981 & up
 Tractors 5610, 6610, 6710, 7610, 7710, 7910

REPLACES Brake Repair Kits



8NAA2250 Brake repair kit, less shoes. For tractors 8N
\$32.24 (1948 to 1952); NAA (1953 to 1954).
NCA2250 Brake Repair Kit, less shoes. Tractors; 501, 600,
\$72.02 700, 800, 900, 2000, 4000, (1955-1964).

REPLACES Brake Rod Seal

D9NN2N89AA Seal for brake pedal shaft, 2
\$2.47 required. For tractors 2000, 3000,
 4000, 5000, 7000, (1965 to 1975);
 2600, 3600, 4100, 4600, 5600,
 5700, 6600, 6700, 7600, 7700,
 (1975 to 1981); 2610, 3610, 4110,
 4610, 5610, 6610, 6710, 7610,
 7710, (1981 to -). Replaces
 C5NN2N258C, D2NN2N258A.



C5NN2N336A Brake rod seal. Seals disc brake
\$4.08 housing against dirt & water.



REPLACES Brake Parts For Wheel & Handbrake

C5NN1126E Brake drum, cast iron. For
\$97.37 tractors 2000 with differential
 lock. 3000 (except 3550); 4110
 with diff. lock (1965-1975); 2000
 less diff. lock, 4110 less diff. lock
 (4/1968-1975); 2600, 3600, 231,
 233, 333, 335, 531 (1975-1981).



C5NN2472H Spring for clutch & brake lever
\$3.89 assist. For
 tractors 3550, 4000, (11-1972 to
 -); 5100,
 7100, (1965 to -); 420, 515, 532,
 535,
 4600, 5600, 5700, 6600, 6700,
 7600,
 7700, (1975 to 1981).



C5NN2N320A Spring, rear wheel brake disc return. For tractors
\$1.68 3550, 4000 (except 4110), 5000, 7000
 (1965-1975; 3900, 4100, 4600, 5600, 5700,
 6600, 6700, 7600, 7700, 420, 515, 532, 535
 (1975-1981); 2810, 2910, 3910, 4110, 4610,
 5610, 5900, 6610, 6710, 7610, 7710, 7810,
 7910, 8210 (1981-10/1991); 3230, 3430, 3930,
 4130, 4630 (3/1990-); 5640, 6640, 7740, 7840,
 8330 with mechanical brakes (11/1991-); 5610S,
 6610S, 7610S, 7810S (1/1994-).

350920S8 Stud, brake support plate. **EXACT of ORIGINAL.**
\$4.28 For tractors; 8n, NAA (1948 TO 1953).

8N2224 Cover, brake camshaft hole. **EXACT of ORIGINAL.** For tractors; 8N, NAA (1948 TO
\$4.89 1954).

C0NN2477 Bushing, brake cross shaft. Press
\$6.63 into transmission housing. For
 tractors: 8N, NAA, {1949-1954}.



782477 Bushing, brake cross shaft. Press
\$6.63 into transmission housing {one
 on each side} For tractors: 9N,
 2N, Early 8N {1939-1949}.



8N2322 Spring, brake camshaft hole
\$3.39 cover. For tractors: 8N, Jubilee,
 NAA, 600, 601, 700, 701, 800,
 801, 900, 901, 2000, 4000
 {1948-1964}.



REPLACES

Clutch Pedal Parts

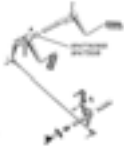

9N7508 Bushing, clutch pedal arm. 1.002 I.D. x 1-1/4 long. For tractors: 9N, 2N, (1939 to 1947).
\$6.42

8N7508B Bushing, clutch pedal arm. 1.002 I.D. x 1-1/2 long. For tractors: 8N, NAA (1948 to 1954).
\$6.42

REPLACES

Tru-Power Clutch Kits

8N7563NC Clutch kit for 9" single clutch. Kit contains remanufactured 9" pressure plate assembly, 6 springs, **NEW** 9" disc, 10-spline, 1-3/8" hub, new release and pilot bearings. For tractors with 3- or 4-speed transmission: 9N, 2N, 8N, (1939 TO 1952); 600, 700, 800, 900, (1953 to 1957).
\$177.56



NDA7563AK Clutch kit for 10" single clutch. Kit contains remanufactured 10" pressure plate assembly, 8 springs; remanufactured 10" disc, 15-spline, 1" hub; new release and pilot bearings. For tractors with 4- or 5-speed transmission 600, 700, 800, 900, 2000, 4000, (1953 to 1964).
\$205.97



311435K Clutch kit for 9" double clutch. Contains remanufactured 9" pressure plate assembly, 12 springs, 6 levers, remanufactured 9" engine disc, 15-spline, 1" hub; remanufactured 9" PTO disc, 29-spline, 1-7/8" hub, new release and pivot bearings. For live PTO double clutch models from (1955 to 1964), tractor series 600, 700, 800, 900, Dexta, Super Dexta.
\$506.00



6X7502W10K
\$569.79

Double clutch assembly, 11" X 8-1/2", with 8-1/2" PTO disc. Includes 11" clutch disc, 10-spline, 1" hub, woven facing. For tractors 2000, 3000, 4100, (1965 to 9-1969) (6-1971 to 1975); 2600, 3600, 231, 233, 333, 531, (1975 to 1978); 2310, 2610, 3610, 230A, 231, 234, 334, 530A, 531, (1981 to 4-1983).



6X7502P10K
\$932.78

Double clutch assembly, 11" x 8-1/2", with 8-1/2" PTO disc. Includes 11" clutch disc, 10-spline, 1" hub, 4 button/pad type facing. (10/1969-5/1971).



6X7502W15K
\$529.31

Double clutch assembly, 11" x 8-1/2", with 8-1/2" PTO disc. Includes 11" clutch disc, 15-spline, 1" hub, woven facing. (1965-9/1969).



REPLACES

Clutch Pressure Plate Assemblies

C9NN7563D
\$244.41

Pressure plate assembly, 11" single clutch. For tractors 2000, 3000, (10-1969 to 5-1971).



D0NN7563A
\$244.41

Pressure plate assembly, 11" single clutch. For tractors 2000, 3000, (6-1971 to 1975); 5000 (10-1969 to 5-1971); 2600, 3600, 321, 233, with transmission PTO or less PTO (1975 to 1981).



E6NN7563BA
Call for Price

Pressure plate assembly, 11" single clutch. For tractors 2610, 3610, less independent PTO (1981 to 12-1984). Replaces E0NN7563DA.



C9NN7563E
\$244.41

Pressure plate assembly, 11" single clutch. For tractors 4000 with transmission PTO or less PTO (10-1969 to 9-1971).



D8NN7563DB
\$251.78

Pressure plate assembly, 11". For tractors 4100, 4140, 4400, 4500, (1969 to 9-1971) with independent PTO, 4110, 4610, 4610SU, (1981 & up); 4200 (1969 to 9-1975) with independent PTO.



C5NN75963U
\$252.62

Pressure plate assembly, 11". For tractors with independent PTO: 4000, 4100, 4200, (1965 to 1969); 4000, 4100, 4140, (10-1971 to 9-1975); 4100, 4600, 4600SU, (10-1975 to 1981).



E0NN7563CA
\$217.95

Pressure plate assembly, 12" single clutch. For tractors 5000 (1965 to 9-1969) and 6-1971 to 1975); 5600, 5700, 6600, 6700, (1975 to 1981); 5610, 6610, (1981 to 9-1985). Replaces C7NN7563B.



D8NN7563AB
\$231.99

Pressure plate assembly, 13" single clutch. For tractors 5000 (1965 to 9-1969); 7000 (10-1971 to 1975); 7600, 7600, (1975 to 1981); 6710, 7610, 7710, (1981 to -). Replaces D2NN7563A, D2NN7563B, D8NN7563AA.



REPLACES

Double Clutch Assembly

D8NN7502AA
\$420.87

Double-clutch assembly, 11" x 8-1/2", same as supplied by OEM with 8-1/2", PTO disc. Does not include engine clutch disc. For tractors 2000, 3000, 4100 (1965-9/1969 & 6/1971-1975); 2600, 3600, 2610, 3610, 340A, 231, 234, 334, 530A, 531 (1981-4/1983). Can replace D8NN7502BA, E0NN7502AA.



C5NN77641B
\$72.36

PTO disc, 8-1/2", 29-spline, 1-7/8" hub. For double-clutch tractors 2000, 3000 (1965-1975); 2600, 3600 (1975-1981); 2610, 3610 (1981-). Used with double-clutch D8NN7502BA, D8NN7502AA, E0NN7502AA.



C7NN7550V
\$90.95

Clutch disc, 11", 15-spline, 1" hub. single-clutch tractors with independent PTO 4100, 4110, 4200, 4410, (1965 to 9-1969); 4100 (10-1971 & up).

C7NN7550AC
\$121.83

Clutch disc, 11", 10-spline, 1" hub, button/pad type facing. For single- and double-clutch tractors 2000, 3000, 4000, 4110, (10-1969 to 5-1971).



D1NN7550A
\$100.22

Clutch disc, 11", 10-spline, 1" hub, woven facing. For tractors (6-1971 & up).



REPLACES

Clutch Discs 1939 Thru 1964

91A7550WHD
\$49.15

Clutch disc, 9", spring loaded, with woven heavy duty facings, 10 spline, 1-3/8" hub. For tractors 9N, 2N, 8N, 4-speed NAA, 600, 700, 800, 900 prior to s/n 14257 (1953 to 1957).



NCA7550A
\$79.53

Clutch disc, 10", 10-spline, 1-3/8" hub. For tractors NAA, 600, 700, 800, 900 4-speed transmission prior to s/n 14257 (1953 to 1957) when retrofit from original 9" clutch.



C0NN7550C
\$90.45

Clutch disc, 10" heavy-duty, 15-spline, 1" hub. For tractors 600, 700, 800, 900 5-speed transmission prior to s/n 14257, (1953 to 1957); 501, 601, 701, 801, 901, 4- & 5-speed transmissions after s/n 14257, (1958 to 1964). Can replace NDA7550B.



C7NN7550AC
\$121.83

Clutch disc, 11", 10-spline, 1" hub, button/pad type facing. For single- and double-clutch tractors 2000, 3000, 4000, 4110, (10-1969 to 5-1971).

**C5NN77641B**
\$72.36

PTO disc, 8-1/2", 29-spline, 1-7/8" hub. For double-clutch tractors 2000, 3000 (1965-1975); 2600, 3600 (1975-1981); 2610, 3610 (1981). Used with double-clutch D8NN7502BA, D8NN7502AA, E0NN7502AA.

**C7NN7550V**
\$90.95

Clutch disc, 11", 15-spline, 1" hub, woven facing. For tractors (1965 to 9-1969). Replaces C7NN7550C.

**C7NN7550AA**
\$95.19

Clutch disc, 11", 15-spline, 1" hub. Single-clutch tractors with independent PTO 4100, 4110, 4200, 4410, (1965 to 9-1969); 4100 (10-1971 & up).

**D1NN7550A**
\$100.22

Clutch disc, 11", 10-spline, 1" hub, woven facing. For tractors (6-1971 & up).

**E3NN7550EA**
\$65.58

Clutch disc, 12", 25-spline, 1-5/8" hub, woven facing. For tractors 5000 (1965 to 9-1969 and 10-1971 to 1975); 5600, 6600, 5700, 6700, (1975 & up)w/o dual-power. Replaces C7NN7550Z.

**E7NN7550DA**
\$94.31

Clutch disc, 12", 10-spline, 1-3/4" hub. For single-clutch tractors 5000 with dual-power (1973 to 1975); 5600 w/dual-power (1975 to 1981); 5700, 6600, 6700, (1975 to 1981); 5610, 5900, 6610, 6710, (1981 to 10-1991). Replaces D2NN7550B, D7NN7500A.

F0NN7550BA
\$117.77

Clutch disc, 13", 10-spline, 1" hub, no damper springs. For single-clutch tractors 3550, 4400, 4410, 4500 with 8-speed transmission, (10-1971 to 1975); 4600, 335, 420, 515, 532, 535, (1975 to 1981); 2810, 2910, 3910, 4110, 4610, (1985 to 2-1990). Replaces D1NN7550B, E3NN7550BA.

E7NN7550EA
\$114.00

Clutch disc, 13", 10-spline, 1-3/4" hub, with damper springs. For single-clutch tractors 7000 with dual-power (1973 to 1975); 5600, 5700, 6600, 6700, 7600, 7700, (1975 to 1981); 5610, 6610, 6710, 7610, 7710 with 16 X 4 or 16 X 8 transmission, (1981 to 10-1991); 5610S, 6610S, 7610S, 7810S, (1994 to -). Replaces D9NN7550AB, E9NN7550BA, 82001667.

**E8NN7550KA**
\$125.58

Clutch disc, 13" heavy-duty clutch, 25-spline, 1-5/8" hub. For tractors 5000 (1965 to 9-1969); 7000 (10-1971 & up) less dual-power; 5100, 5200, (1965 to 1969) with independent PTO; 5100, 5200, 7100, 7200, (10-1971 to 9-1975)less dual-power w/independent PTO; 6600, 6700, (10-1975 TO 1981).

**D1NN7550C**
\$276.03

Clutch disc, 13", 10-spline, 1-3/4" hub, 9 pads. For single-clutch tractors 8000, 8700, 9000, 9700, (1969 to 1978).

REPLACES

Clutch Pilot Bearings

C5NN7600A
\$5.00

Clutch pilot bearing. I.D. 0.669", O.D. 1.574", width 0.472". For 9" models except NAA (1939 - 1964), 3-cyl models except 12" & up (1965-).

F0NNN779AA
\$16.37

Bearing, for PTO drive plate. I.D. 1.4370", O.D. 2.6772", W. 0.5906". For 12" clutch models 5000 (1965 to 9-1969 and 6-1971 to 1975); 13" clutch models (1965 to 9-1969); 13" clutch-woven 7000 (10-1971 & up); pad-type clutch models 5000 (10-1969 to 5-1971).

REPLACES

Clutch Release Bearings

CONN7580A
\$23.07

Clutch Release Bearing. I.D. 2.062", O.D. 3.562", W. 0.796". For 9" & 10" single-clutch models (1939-1964); 11" single-clutch models with transmission PTO 3600 with 6-speed; 2600, 3600 with 8-speed or less PTO (1975 & up). Grease-type also replaces 78-7580A.

D8NN7580BB
\$33.71

Clutch Release Bearing. I.D. 2.499", O.D. 4.070", W. 0.870". For single-clutch models 4000 series with independent PTO (except 4400, 4500) (1965-9/1969); single-clutch models 2000, 3000, 4110 with 6- & 8-speed transmission.

NDA7580B
\$33.71

Clutch Release Bearing. I.D. 2.500", O.D. 4.125", W. 0.870". For 9" double-clutch models with 5-speed transmission.

78-7580A
\$23.07

Clutch release bearing assy. I.D. 2.065", O.D. 3.500", W. 0.7500". For models with 8" & 9" single-clutch (to 1964). Can replace CONN7580A.

D8NN7580CA
\$30.00

Clutch Release Bearing. For tractors TW20, TW30 (1979-1982); TW15, TW25, TW35 (1983-2/1991); 8630, 8730, 8830 (3/1990-).

REPLACES

Shifter Knob & Cover

BB7213A
\$3.81

Knob, transmission gear-shift lever. For all 4- & 5- speed transmission models (1950-1964 S/N 252844 & up).

**C5NN7213A**
\$3.39

Knob assembly for gear-shift lever. For tractors 2000, 3000, 4000, 5000, 7000 (1965-1974); 2600, 3600, 4100, 4600, 5600, 7600, 231, 233, 335, 420, 515, 532, 535 (1975-1981); 2610, 2810, 2910, 3610, 3910, 4110, 4610, 5610, 5900, 6610, 7610 (1981-1991); 3230, 3430, 3930, 4130, 4630 (3/1990-).

**E440GB9**
\$2.89

Ball, 1-1/4" dia. for high-low gear-shift lever. For tractors 2000, 3000, 4000, 5000, 7000 (1965-1975); 2600, 3600, 3900, 4100, 4600, 5600, 6600, 7600, 231, 233, 335, 420, 515, 531, 532, 535 (1975-1981). Also used on hydraulic control lever, tractors 2600, 3600, 4100, 4600, 5600, 5700, 6600, 6700, 7600, 233, 333, 420, 515, 535 (1975-1981).



REPLACES

Gear Shift Lever Seal

C5NN7277C
2.55

Boot seal for gear shift lever. Fits all 4-speed transmissions. For all 4-speed transmission models (1939-1964). Supercedes 8N7277, CONN7277.

8N7277
\$7.97

Transmission gear shift lever boot. For tractors: 9N, 2N, 8N, NAA (1939-1954).

REPLACES

Transmission Gears, & Countershafts

8N7111
\$226.38

Transmission Countershaft. For 8N (1948-1952).

**B9NN7114A**
\$101.69

Gear, transmission countershaft, second gear. For 8N (1948-1952); NAA w/4-speed transmission (1953-1964) 17 teeth. Original gear was 18 teeth.

**B9NN7A381B**
\$123.03

Gear, transmission mainshaft second gear. For models 8N w/4-speed transmission (1948-1952); NAA w/4-speed (1955-1964). 56 teeth.



C5NN7N109A Countershaft. For models 600, 700, 800, 2000, 4000 (1955-1964); 2000, 3000 4-speed w/transmission PTO (1965-1970). Can replace NDA7111C.
\$229.20

REPLACES **Transmission Bearing and Seal Kits**

TSBK3952 For tractors: 9N, 2N, 8N with 3 & 4 speed transmission (1939-52).
\$106.85



Kit contains:
 2 - 9N7086 gaskets, 1 - 9N4662 gasket,
 1 - D5NN7223A gasket, 1 - 9N7223B gasket, 1 - 8N7052A oil seal, 1 - 15385-TIM bearing cone, 4-25877 bearing cones, 4 - 25820 bearing cups.

TSBK5354 For tractors: NAA, all 4 speed transmissions, (1953-54).
\$111.12



Kit contains:
 2 - 9N7086 gaskets, 1 - D5NN7223A gasket,
 1 - NAA4662B gasket, 1 - 8N7052A oil seal, 2 - D6NN7R240A seals, 1 - 15385-TIM bearing cone, 4-25877 bearing cones, 4 - 25820 bearing cups.

TSBK5564 For tractors: 600, 700, 800, 900, 2000, 4000, using 4 speed transmissions, (1955-64). contains:
\$126.77

2 - 9N7086 gaskets, 1 - D5NN7223A gasket, 1 - NCA44025A gasket, 1 - 310590 gasket, 1 - 2789-TIM bearing cone, 1-8N7052A oil seal, 2 - D6NN7R240A seals, 1 - 15385-TIM bearing cone, 3 - 25877 bearing cones, 3 - 25820 bearing cups, 1 - 2735X-TIM bearing cup.

REPLACES **Transmission Drain Plug & Gaskets**

9N7010 Transmission drain plug. 2.5 outside diameter. For tractors: 9N, 2N, 8N, NAA, {1939-1954}. Also filler plug for tractor:NAA {1953-1954}.
\$9.27



8N7011 Gasket, transmission drain plug; transmission filler plug except NAA; rear axle housing filler plug; hydraulic lift cover plug. For all models 1939 to date.
\$0.75

0N7086 Gasket, transmission main drive gear bearing retainer. For 9N, 2N, 8N.
\$0.38



9N7223B Gasket, transmission gear shift cover. For 9N, 2N.
\$3.95

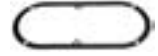

D5NN7223A Gasket, transmission gear shift cover plate. For 8N (1948-1952), models w/4-speed transmission (1953 & up).
\$2.10



NDA7223A Gasket, transmission gear shift cover plate. For models with 5-speed transmission (1955-1964).
\$2.13



REPLACES **Transmission Bearings**

9N7066 Cone, main drive gear, countershaft, output shaft. For models (to 1970). (Mfr. 25877)
\$10.50

NCA7066A Bearing Cone, transmission output shaft, rear. For models (1955-1970). (Mfr. 2789)
\$18.29



9N7067 Cup, main drive gear, countershaft, output shaft. For models (to 1970). (Mfr. 25820)
\$11.43

NCA7067A Bearing Cup, output shaft. For models (1955-1970). (Mfr. 2735X)
\$19.73



9N7120 Cone, main shaft piolet. For models 1970. (Mfr. 15385)
\$26.34

8N779A Cone, main cluster gear front (Mfr. 14138A) 5-speed transmissions.
\$8.01

8A4221 Cone, PTO countershaft (Mfr. 24780) 5- speed transmissions.
\$17.63

NDA77058A Cup, output gear bearing front (Mfr. 28920) 5-speed transmissions.
\$8.45

NDA77060A Cone, output gear bearing front (Mfg. 28985) 5-speed transmissions.
\$20.57

NDA77121A Cup, main cluster gear brg. front (Mfr. 14274) 5-speed transmissions.
\$6.05

- NDA77123A** Cone, countershaft brg. rear (Mfr. 26882)
\$10.65
5-speed transmissions.
- NDA77124A** Cup, countershaft bearing rear (Mfr. 26823)
\$8.25
5-speed transmissions.
- NDA77150A** Cup, countershaft bearing ret. front (Mfr. 24720)
\$6.00
5-speed transmissions.

REPLACES

Transmission Oil Seals

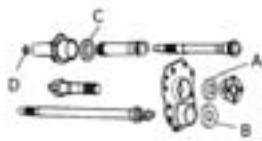

- 8N7052A** Seal, transmission drive gear. For tractors 9N,
\$3.90
2N, 8N, (1939 to 1952); all models (1965 to 1970).
- D6NN7R240A** Seal, countershaft. For tractors NAA, 600, 700,
\$3.90
800, 900, 2000, series 4- & 5-speed transmissions (1953 to 1964).
- 120-OR** O-ring, transmission reverse idler gear bracket
\$0.66
to case. For 5-speed transmission (1955 to 1964). Replaces 87085S94.
- 87051S94** O-ring, intake tube to valve pump. For 4-speed
\$0.29
transmission models.
- D9NN7R510BA** Oil seal, transmission (w/trans, PTO). I.D.
\$3.66
1.0675", O.D. 2.1940", W. 0.5000". For tractors Dexta, (1957 to 1964); 2000, 3000, 4000, 6, 7 & 8 speed trans., 4100, 4600, 8 speed trans., (1975 to 1981); 2610, 3610, 6 & 8-speed trans., 4110, 4610, 8-speed trans., (1981 to -). Replaces E81GD9. (C)
- D9NNC729BA** Oil seal, transmission (w/live/ind. PTO). I.D.
\$3.71
3.125", O.D. 3.130", W. 0.5000". For tractors Dexta, Super Dexta, (1957 to 1964); 2000, 3000, 4000, 6, 7 & 8 speed trans., (1965 to 1975); 2600, 3600, 6 & 8-speed trans., 4100, 4600, 8-speed trans., (1975 to 1981); 2610, 3610, 4110, 4610, 8-speed trans., (1981 to -). Replaces E81GD9. (C)
- D9NN7048BA** Oil seal, transmission. I.D. 3.125" O.D. 3.130",
\$5.04
W. 0.375". For tractors 5000, 7000, 7 & 8-speed trans., (1965 to 1975); 5600, 6600, 6700, 7600, 7700, 8-speed trans., (1975 to 1981); 5610, 6610, 6710, 7610, 7710, 8-speed trans., (1981 to -). Replaces D2NN7048A, D9NN7048AA.

- 957E727A**
\$3.02

Oil seal, transmission (w/live/ind. PTO).I.D. 1.499" O.D. 1.503", W. 0.250". For tractors Dexta, Super Dexta, (1957 to 1964); 2000, 3000, 4000, 6, 7 & 8-speed trans., (1964 to 1975); 2600, 3600, 6 & 8-speed trans., 4100, 4600, 8-speed trans., (1975 to 1981); 2610, 3610, 4110, 4610, 8-speed trans., (1981 to -).

- C5NN799A**
\$4.61

Oil seal transmission. I.D. 1.561", O.D. 1.565", W. 0.250". For tractors 5000, 7000, 7 & 8-speed trans., (1965 to 1975); 5600, 6600, 6700, 7600, 7700, 8-speed trans., (1975 to 1981); 5610, 6610, 6710, 7610, 7710, 8-speed trans., (1981 to -).

- C5NN77086A**
\$4.92

Oil seal transmission. For tractors 2000, 3000, 4000, 5000, 7000, 7 & 8-speed trans., (1965 to 1975); 2600, 3600, w/trans. PTO, 6 & 8-speed trans., 4110, 4610, 8-speed trans., (1975 to 1981); 2610, 3610, 6 & 8-speed trans., 4110, 4610, 8-speed trans., (1981 to -). (A)

- E62GE9**
\$5.16

Oil seal, transmission. For tractors Dexta, Super Dexta, (1957 to 1964); 2000, 3000, 4000, 6, 7 & 8-speed trans., 5000, 7000, 7 & 8-speed trans. (1965 to 1975); 2600, 3600, 6 & 8-speed trans., 4100, 4600, 5600, 6600, 6700, 7600, 7700, 8-speed trans., (1975 to 1981); 2610, 3610, 6 & 8-speed trans., 4100, 4610, 5610, 6610, 6710, 7610, 7710, 8-speed trans., (1981 to -).

REPLACES

Shifter Forks, Plates, & Covers

- C7NN721A**
Call for Price

Shifter plate. For power take-off assembly with 6-, 7-, & 8-speed & manual reversing transmission in tractors 2000, 3000, 4000, (1965 to 1974); 2600, 3600, 231, 233, 333, 420, 515, 531, 532, 535, (1975 to 1981); 2310, 2610, 2810, 2910, 3610, 3910, 234, 334, (1981 to 2-1990).



- C5NN7211F**
Call for Price

Cover assembly. For transmission case with 6-, 7-, & 8-speed transmission in tractors 2000, 3000, 4000, (1965 to 1974).



REPLACES

Differential Gears, Pinions, Bearings, & Related Parts



SEE NEXT PAGE FOR PRICES

Application	Matched Set with Bolts and Nuts	Ring Gear	Pinion	Front Pinion Cone	Front Pinion Cup	Rear Pinion Cone	Rear Pinion Cup	Pinion Seal	Differential Cone (J)	Differential Cup (K)
Tractor: 9N, 2N, 8N				BB4621B	BB4616B	BB4621B	BB4616B		BB4221B	BB4222
Tractor: NAA	RGP60	CEPN4210B	NAA4609E	BB4621B	BB4616B	BB4621B	BB4616B		BB4221B	BB4222
Tractor: 600	RGP65	CEPN4210B	NCA4609B	D1NN4N028A	NCA4616A	NCA4630A	TBAA4628A	312356	BB4221B	BB4222
Tractor: 601, 2120	RGP70	CEPN4210B	C0NN4609K	D1NN4N028A	NCA4616A	NCA4630A	TBAA4628A	312356	BB4221B	BB4222
Tractor: 800				D1NN4N028A	NCA4616A	NCA4630A	NDA4628A	312356	NDA4221A	NDA4222A
Tractor: 801, 4120				D1NN4N028A	NCA4616A	NCA4630A	NDA4628A	312356	NDA4221A	NDA4222A
Tractor: DEXTA (-1962)				BB4621B	BB4616B	BB4621B			BB4221B	BB4222
Tractor: DEXTA (1962-)				HM903249		HM903249			BB4221B	BB4222
Tractor: 2000, 3000, 4110				HM903249		HM903249			BB4221B	BB4222
Tractor: 3500				D1NN4N028A	NCA4616A	NDA4630A	NDA4628A			

REPLACES

Nut for Differential Lock



C5NN4N001A

Nut, differential lock. For tractors 2000 (except 2150), 3000 (except 3550), 4110 (1965-1975); 2600, 3600, 231, 233, 333, 335, 531 (1975-1981).

REPLACES

Differential Pinion Gears



79-4230

Pinion gear washers, (4) required.

7RT4215

Pinion gears, (4) required.

MATCHED SET WITH BOLTS AND NUTS

RGP60	Call for Price
RGP65	Call for Price
RGP70	\$541.08

RING GEAR

CEPN4210B	Call for Price
-----------	----------------

PINION

NAA4609E	Call for Price
NCA4609B	\$157.50
C0NN4609K	\$196.91

FRONT PINION CONE

D1NN4N028A	\$21.29
HM903249	\$24.59

FRONT PINION CUP

BB4621B	\$30.42
BB4616B	\$30.32
NCA4616A	\$9.38

REAR PINION CONE

BB4621B	\$30.42
NCA4630A	\$32.18
HM903249	\$24.59

REAR PINION CUP

BB4616B	\$30.32
TBAA4628A	\$15.42
NDA4628A	\$13.14

PINION SEAL

312356	Call for Price
--------	----------------

DIFFERENTIAL CONE (J)

NDA4221A	\$27.48
----------	---------

DIFFERENTIAL CUP (K)

BB4221B	\$18.18
BB4222	\$9.05
NDA4222A	\$16.46

NUT FOR DIFFERENTIAL LOCK

C5NN4N001A	\$14.52
------------	---------

DIFFERENTIAL PINION GEARS

79-4230	\$1.86
7RT4215	\$23.49

REPLACES

Differential Gears & Spider

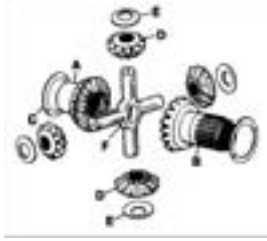

DDN4213B
\$46.68

Gear, differential spider. For tractors Major, Super Major (11/1960-1964); Dexta, Super Dexta (1957-1964); 2000, 3000, 4000, 5000, 7000 (1965-1975); 2600, 3600, 4100, 4600, 5600, 5700, 6600, 6700, 7600, 7700 (1975-1981); 2610, 3610, 4110, 4610, 5610, 6610, 6710, 7610, 7710 (1981-). Replaces 957E4292B. (Ref. D)

508E4230A
\$4.85

Thrust washer, for differential spider gear. For tractors Major, Super Major (11/1960-1964); Dexta, Super Dexta (1957-1964); 2000, 3000, 4000, 5000, 7000 (1965-1975); 2600, 3600, 4100, 4600, 5600, 5700, 6600, 6700, 7600, 7700 (1975-1981); 2610, 3610, 4110, 4610, 5610, 6610, 6710, 7610, 7710 (1981-). (Ref. E)

REPLACES

Bolts & Nuts for Differential Ring Gear

NAA44215A
\$4.83

Bolt, differential ring gear-1/2"-20. For all models; NAA, 600, 700, 800, 900, 2000, 4000 series (1953-1964). 12 required for ring gear CEPN4210B, 16 required for ring gear CEPN4210C.

34032S34
\$1.25

Nut, slotted. For tractors NAA 44215A bolt tractors ; NAA, 600, 700, 800, 900, 2000, 4000 series (1955-1964).

E94EB9
\$1.79

Bolt, ring gear to differential case. For tractors 2000, 3000, 4000, 5000, 7000 (1965-1975); 2600, 3600, 4100, 4600, 5600, 5700, 6600, 6700, 7600, 7700 (1975-1981); 2610, 3610, 4110, 4610, 5610, 6610, 6710, 7610, 7710 (1981-).

380135S43
\$1.50

Nut for ring gear bolt. For tractors 2000, 3000, 4000, 5000, 7000 (1965-1975); 2600, 3600, 4100, 4600, 5600, 5700, 6600, 6700, 7600, 7700 (1975-1981); 2610, 3610, 4110, 4610, 5610, 6610, 6710, 7610, 7710 (1981-).

REPLACES

Center Housing and Differential Gaskets & Gasket Kit



DGK928
\$7.94

Diff. gasket kit, 6 pieces. For tractors 9N, 2N, 8N.

DGKNAA
\$10.28

Diff. gasket and o-ring kit: 13 pieces. For tractors NAA (1953-1954).

DGK679
\$7.62

Diff. gasket and o-ring kit: 13 pieces. For tractors 600, 700, 900.

DGK800
\$8.27

Diff. gasket and o-ring kit. For tractors series 800.

2N4035
\$1.10

Gasket center housing to rear axle hsg. For tractors 9N, 2N, 8N.

NAA4036A
\$1.25

Gasket center housing to rear axle hsg. For tractors NAA, 600, 2120, LCG (1953-).

NDA4036A
\$1.86

Gasket center housing to rear axle housing. For tractors 800, 4120, 801 w/h.d. front end, h.d. ind.

9N4131
\$0.51

Diff. gasket center housing side cover. Except NAA; shifter plate cover to diff. housing; all 1939 & up.

9N4662
\$1.29

Gasket center housing to transmission case. For tractors 9N, 2N, 8N.

NAA4662B
\$1.95

Gasket center housing to transmission case. For NAA.

NCA44025A
\$1.64

Gasket center housing to transmission case. For 4-speed to S/N 14256.

310590
\$1.65

Gasket center housing to transmission case. For 5-speed to S/N 14256 & after (1958 & up).

REPLACES

Rear Axle, Hub, Bearing & Wheel

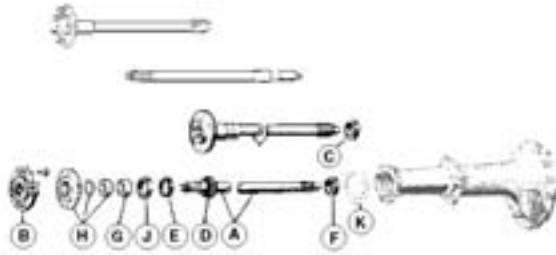

SEE NEXT PAGE FOR PRICES

Application	Axle Shaft/Hub Assy.	Axle Shaft Collar	Axle Shaft Cone	Axle Shaft Cup	Inner Oil Seal	Outer Oil Seal	Outer Retainer
Tractor: 9N, 2N		9N4132	2N4221	9N4222		D6NN4251A-PAIR	
Tractor: 8N (to s/n 486753)	8N4235C	8N1171		2N4221	9N4222		A8NN4251A-PAIR
Tractor: 8N (486753 and up), NAA	8N4235C	8N1171		2N4221	9N4222	8N4233A-PAIR	D5NN4115A-PAIR
Tractor: 600, 2120 1-3/4" 16 spline coarse		NCA4132A	NCA44224A	9N4222	C4NN4233A-PAIR	D5NN4115B-PAIR	
Tractor: 700, 900			NCA7066A	NCA7067A		D5NN4115B-PAIR	
Tractor: 800, 4120 2" 16 spline coarse		NCA4132A	NCA44224A	9N4222	C4NN4233A-PAIR	D5NN4115B-PAIR	
Tractor: 600, 2110 1-3/4" 34 spline fine		NCA4132A	NCA44224A	9N4222	C4NN4233A-PAIR	D5NN4115B-PAIR	
Tractor: 800, 4120 1-3/4" 38 spline fine		NCA4132A	NCA44224A	9N4222	C4NN4233A-PAIR	D5NN4115B-PAIR	
Tractor: DEXTA, 2000, 3000 (1965 & up)			E18EB9	E19EB9	C9NN4N109A	C5NN4115B	

REPLACES

Rear Axle Oil Seals & Gaskets

SS92	Rear axle seal. For tractors 9N, 2N.
379313S91	O-ring, axle housing to center housing. For tractors 4000, 5000, 7000 (1965-1975); 4100, 4600, 5600, 5700, 6600, 6700, 7600, 7700, (1975 to 1981); 4110, 4610, 5610, 6610, 6710, 7610, 7710 (1981-).
C9NN4N109A	Rear axle inner seal. I.D. 1.869", O.D. 2.750", W. 0.5045". For tractor series 2000, 3000 (1965-). Replaces C5NN4233A.
8N4290	Gasket, inner. For retainers 8N4248B & A8NN4248A, insert gasket before seal.
C5NN4115B	Rear axle outer seal. I.D. 2.9975", O.D. 3.3375", W. 0.4985". For tractor series 200, 3000 (1965-). Used with inner seal C9NN4N109A.

C5NN4969D

Seal & retainer assembly, outer, for rear axle shaft. For tractors 3910 (5/1983-); 4000 (1965-1975); 4100, 4600 (1975-1981); 4110, 4610 (5/1983-); 3910 (5/1983-).

8N4225

Gasket, outer. For 8N4248B & A8NN4248A. Gasket is included with retainer assembly A8NN4248A.

C5NN4969E

Seal & retainer assembly, outer, for rear axle shaft. For tractors 5000, 7000 (1965-1974); 5600, 5700, 6600, 6700, 7600, 7700 (1975-1981); 5610, 6610, 6710, 7610, 7710 (1981-6/1986).

8N4284

Cork composition seal. For 8N, NAA. (J) in illustration above chart.

9N4130

Paper gasket/shim. Use for seal between bearing retainer, axle housing, or backing plate. Use in multiples to replace shims 8N4229. (K) in illustration above chart.

F-4-181-A

AXLE SHAFT/HUB ASSY.

8N4235C \$173.48

AXLE SHAFT COLLAR

9N4132 \$11.74
 8N1171 \$72.26
 NVA4132A \$13.73

AXLE SHAFT CONE

2N4221 \$43.52
 NCA44224A \$52.92
 NCA7066A \$18.09
 E18EB9 \$25.92

AXLE SHAFT CUP INNER OIL SEAL

9N4222 \$6.61
 9N4222 \$6.61
 2N4221 \$43.52
 C4NN4233A-PAIR \$8.09
 NCA7067A \$19.73
 C9NN4N109A \$5.58
 E19EB9 \$11.00

OUTER OIL SEAL

D6NN4251A-PAIR \$13.91
 8N4233A-PAIR \$8.09
 D5NN4115B-PAIR \$12.22
 C5NN4115B \$4.95

OUTER RETAINER

A8NN4251A-PAIR \$21.32
 D5NN4115A-PAIR \$11.60

REAR AXLE OIL SEALS & GASKETS

SS92 \$10.30
 379313S91 \$4.07
 C9NN4N109A \$5.58
 8N4290 \$0.51
 C5NN4115B \$4.95
 C5NN4969D \$21.06
 8N4225 \$1.23
 C5NN4969E \$16.38
 8N4284 \$2.24
 9N4130 \$0.75

REPLACES

Rear Axle Nut & Ring Kit



CBPN4179A
\$6.98

Kit, nut & snap ring. For tractors 8N (1948-1953); NAA (1953-1955).

8N4179
\$5.25

Nut only, threads 1.25"-18. For tractors 8N (1948-1953); NAA (1953-1955).

8N4187
\$1.16

Ring only. For tractors 8N (1948-1953); NAA (1953-1955).

8N4293
\$2.25

Washer for nut 8N4179A. For tractors 8N (1948-1953); NAA (1953-1955).

REPLACES

Wheel Clamp Lock Nut



LN10-2
\$11.12

Clamp lock nut, 3/4"-16 thread. For all Ford models to date except some row crop.

LN10-21
\$20.55

Clamp lock nut, rear axle, 1-1/4". For tractors 8N, NAA.

REPLACES

Conversion PTO Assembly

Complete assembly replaces and converts 1-1/8" shaft on all Ford tractors to 1-3/8" spline. Assembled and ready to install by removing 4 bolts from 9N733B cover, removing & installing complete unit. Includes new 1-3/8" splined PTO shaft, seal, bearing, housing, cap & bearing retainer ring assembled. *Replacement parts for 1-3/8" conversion PTO shaft*



9N700-38
\$133.07

PTO assembly, 30-7/8". For tractors 9N, 2N, 8N.



NAA700-38
\$134.89

PTO assembly, 30-3/16". For tractors NAA (1953-1954).



NCA700-38
\$133.87

PTO assembly, 32-11/16". For tractor series 600, 700, 800, 900.

9N733B
\$23.70

Housing, PTO shaft. For all models originally equipped with 1-1/8" spline PTO shaft or TISCO 1-3/8" conversion. Note: OEM 1-3/8" housing is 310089; not available from TISCO and will not interchange with 9N733B.

9N735B
\$5.97

PTO shaft seal sleeve. For housing 9N733B using OEM production 1-1/8" shaft.



9N710-38
\$106.52

PTO shaft, 30-7/8". Converts standard 1-3/8" in PTO shaft 9N710B to 1-3/8" spline. For tractors 9N, 8N.

NAA710-38
\$106.52



PTO shaft, 1-3/8". Converts standard NAA710B shaft to 1-3/8" splines. For NAA 30-3/16".

NCA710-38
\$104.93



PTO shaft, 32-11/16". Converts standard NCA710B shaft to 1-3/8" splines.

9N735-38
\$4.73



PTO sleeve. I.D. 1.185", O.D. 1.620", L. 1". For shafts above.

NAA722C
\$5.40

Seal retaining collar. I.D. 1.180", O.D. 1.620", L. 2.200". For TISCO's NAA710-38 & NCA710-38.

REPLACES

Replacement Parts for Original Production 1-3/8" Spline PTO Shaft



312428
\$97.14

PTO shaft, heat treated, heavy-duty, 1-3/8". For tractor series 600, 700, 800, 900, 2000, 4000 (1954-1964); except Select-O-Speed (1959 & up).

310087
\$7.32

Sleeve for PTO, 1-3/8" shaft. For tractors 1957 & up.

E75GE9
\$8.15

Ball bearing, PTO shaft front. For tractors (1957 & up) with 1-3/8" shaft & 310089 housing.

314267
\$13.17

Snap ring, 1-3/8" PTO shaft bearing.

REPLACES

PTO Shafts

C5NNA728A
\$96.92

Shaft, PTO rear. Length 29-1/2". For tractors 2000, 3000, 6, 7, 8-speed & manual rev. trans. (1965-1975); 2600, 3600, 6 & 8-speed & manual rev. trans. (1975-1981); 2610, 3610 (1981-4/1983).

C5NNN777A
\$107.51



Drive Plate, 15 teeth, PTO drive. For tractors 5000, 7000 dual-range 8-speed trans. (1965-1975); 5600, 5700, 6600, 6700, 7600, 7700 dual-range 7- & 8-speed trans. (1975-1981); 5610, 6610, 6710, 7610, 7710, dual-range 8-speed trans. (1981-).

D2NNN752C
\$145.65



Shaft, PTO rear lower. For single-speed 540 rpm independent PTO. For tractors 5000, 7000 (1965-5/1973).

D3NN710D
\$179.04



Shaft, PTO rear. Length 30-11/16". For tractors 4000 w/ind. PTO (1965-1975); 4100, 4600, 7 & 8-speed & manual rev. trans. (1975-1981). Replaces C5NN710A.

E4NNN752AA
\$144.21



Shaft, PTO rear lower. For single-speed 540 rpm independent PTO drive shaft. For tractors 5000, 7000 (6/1973-1975); 5600, 5700, 6600, 6700, 7600, 7700 (1975-1981); 5610, 6610, 6710, 7610, 7710 (1981-9/1989); 5610S, 6610S, 7610S (1/1994-12/1994). Replaces D2NNN752B, E3NNN752AA.

C5NN7A684AA
\$261.45



Shaft, 15 teeth, PTO drive. For tractors with dual range 8-speed transmission 5000, 7000, (1965 to 1975); dual range 7- & 8-speed trans. 5600, 5700, 6600, 6700, 7600, 7700, (1975 to 1981); dual range 8-speed trans. 5610, 6610, 6710, 7610, 7710, (1981 to -).



E6NNB728AA
\$160.35

Shaft, PTO drive output, 540 rpm. For single-speed 540 rpm independent PTO drive shaft. For tractors 5000, 7000 (6/1973-1975); 5600, 5700, 6600, 6700, 7600, 7700 (1975-1981); 5610, 6610, 6710, 7610, 7710 (1981-9/1989); 5610S, 6610S, 7610S (1/1994-12/1994). Replaces D2NNN752B, E3NNN752AA.

D8NNB728BC
\$149.69

Shaft, PTO drive output, 540 rpm. For single-speed 540 rpm independent PTO drive shaft. For tractors 5000, 7000, (6-1973 to 1975); 5600, 5700, 6600, 6700, 7600, 7700, (1975 to 1981); 5610, 6610, 6710, 7610, 7710, (1981 to 9-1989); 5610S, 6610S, 7610S, (1-1994 to 12-1994). Replaces D2NNN752B, E3NNN752AA.



E4NNN752AA
\$144.21

Shaft, PTO rear lower. For single-speed 540 rpm independent PTO drive shaft. For tractors 5000, 7000 (6/1973-1975); 5600, 5700, 6600, 6700, 7600, 7700 (1975-1981); 5610, 6610, 6710, 7610, 7710 (1981-9/1989); 5610S, 6610S, 7610S (1/1994-12/1994). Replaces D2NNN752B, E3NNN752AA.



D2NNB728A
\$146.13

Shaft, PTO drive output, 540 rpm. For tractors 5000, 7000 two-speed (6/1973-1975); 5600, 5700, 6600, 6700, 7600, 7700 two-speed (1975-1981); 8000, 9000 (1968-1978).



D2NNB728B
\$151.37

Shaft, PTO drive output, 1000 rpm, 21 splines. For tractors 5000, 7000 two-speed (6/1973-1975); 5600, 5700, 6600, 6700, 7600, 7700 two-speed (1975-1981); 8000, 9000 (1968-1978).



E6NNB728AA
\$160.35

Shaft, PTO drive output, 540 rpm. For single-speed 540 rpm independent PTO drive shaft. For tractors 5000, 7000 (6/1973-1975); 5600, 5700, 6600, 6700, 7600, 7700 (1975-1981); 5610, 6610, 6710, 7610, 7710 (1981-9/1989); 5610S, 6610S, 7610S (1/1994-12/1994). Replaces D2NNN752B, E3NNN752AA.

REPLACES

PTO Oil Seals

D9NN703BB
\$6.00

Oil seal, PTO. O.D. 2.45", I.D. 1-5/8", W. 5/8". For tractors with 1-1/8" & 1-3/8" PTO (1939 to 1964), including 4-, 6-, 7-, 8-speed transmissions 2000, 3000, 3550, 4000, (1965 to 1975); 2600, 3600, 4100, 4600, (1975 to 1981); 2610, 3610, 4110, 4610, (1981 to -). Replaces 9N703B, D8NN703AA, D9NN703BA.

D9NNN710CA
\$3.18

Oil seal, PTO. I.D. 1.4005", O.D. 2.5095", W. 0.4895". For single-speed tractors 5000 (1965 to 1975); 5600, 6600, 6700, 7600, 7700, (1975 to 1981); 5610, 6610, 6710, 7610, 7710, (1981 to -). Replaces C5NNN710B, D9NNN710DA.

REPLACES

Support For PTO Shaft

C7NNN776C
\$39.50

Support, for PTO shaft and drive clutch valve. For single-speed PTO on tractors 5000, 7000, (1965 to 5-1973).



D2NNN776A
\$39.82

Support, for PTO shaft and drive clutch valve. For single- or 2-speed PTO on tractors 5000, 7000, (6-1973 to 1975); 5600, 5700, 6600, 6700, 7600, 7700, (1975 to 1981); 5610, 5900, 6610, 6710, 7610, 7710, (1981 to 1991).



REPLACES

PTO Drive Clutch Parts

373227S
\$1.08

O-ring, inner, for clutch piston. For independent PTO, 540 rpm single-speed or 2-speed 540/1000 rpm. For tractors 5000, 7000 (1965-1975); 5600, 5700, 6600, 6700, 7600, 7700 (1975-1981); 5610, 6610, 6710, 7610, 7710 (1981-10/1991); 5610S, 6610S, 7610S, 7810S (1/1994-).



C0NN7A548A
\$1.71

O-ring, outer, for clutch piston.

C9NNP733A
\$50.55

Feathering spring, heavy duty, .243" thick. For PTO drive clutch, independent single-speed 540 rpm or 2-speed 540/1000 rpm. For tractors 5000, 7000 (1965-1975).



D3NNP733A
\$29.03

Feathering spring, standard, .165" thick. For independent PTO, 540 rpm single-speed or 2-speed 540/1000 rpm. For tractors 5000, 7000 (1965-1975); 5600, 5700, 6600, 6700, 7600, 7700 (1975-1981); 5610, 6610, 6710, 7610, 7710 (1981-10/1991); 5610S, 6610S, 7610S, 7810S (1/1994-).

F1NNN750AA
\$136.08

Hub, PTO drive clutch, 25 teeth and 52 teeth. For independent PTO, single-speed 540 rpm or 2-speed 540/1000 rpm. For tractors 5600, 5700, 6600, 6700, 7600, 7700, (1975 to 1981); 5610, 6610, 6710, 7610, 7710, (1981 to 10-1991). Replaces E0NN750AA.



C0NN7B164B
\$13.11

Clutch friction plate, 5-7/8" O.D., 52 internal splines. For Select-O-Speed transmission, "B" carrier, #1 clutch. For tractors 4000 (except 4110), 5000 (1965-1975).



PBB77573A
\$4.16

Clutch friction plate, 6" O.D., 60 external splines. For PTO on tractors 5000, 7000, single-speed (1965-1975); 5000, 7000, dual-power (6/1973-1975); 5600, 5700, 6600, 6700, 7600, 7700 dual-power or single- & 2-speed (1975-1981); 5610 (1981-); 8000, 9000 (1968-1978). For Select-O-Speed transmission, "B" carrier, #1 clutch. For tractors 4000 (except 4110), 5000 (1965-1975).



REPLACES

PTO Clutch Friction Plates

C0NN7B164A
\$21.99

Clutch friction plate, 5-1/4" O.D., 45 internal splines. For Select-O-Speed PTO, single or 2-speed. For tractors 2000, 3000, 4110 (1965-1975).



1P77518A
\$5.60

Clutch friction plate, 5-1/2" O.D., 3-7/8" I.D., 50 external splines. For Select-O-Speed PTO, single- or 2-speed. For tractors 2000, 3000, 4110 (1965-1975).



C5NNP743A
\$15.23

Clutch friction plate, 5-1/4" O.D., 45 internal splines. For Select-O-Speed PTO, single- or 2-speed. For tractors 4000 (except 4110) (1965-1975).



C8AP7B442A
\$3.47

Clutch friction plate, 5-1/2" O.D., 54 external splines. For Select-O-Speed PTO, single- or 2-speed. For tractors 4000 (4/1968-1975); 4100, 4600 (1975-1981); 4110, 4610 (1981-). Replaces 1P77573A.



REPLACES

PTO Friction Discs

C5NNP743B
\$13.65

PTO friction disc with internal splines. For independent PTO on tractors 4000 (4/1968-1975); 4100, 4600 (1975-1981).



E0NNP743AA
\$21.99

PTO friction disc with internal splines. For independent PTO on tractors 4110, 4600 (1981-).



D3NNP743A
\$13.68

PTO friction disc with internal splines. For PTO on 2-speed tractors 5000, 7000 (6/1973-1975); single- & 2-speed tractors 5600, 5700, 6600, 6700, 7600 (1975-1981).





D1NNP743A
\$13.68

PTO friction disc with internal splines. For single-speed tractors 5000, 7000 (1965-1975); 5600, 5700, 6600, 6700, 7600, 7700 (1975-1981); single- & 2-speed 5610, 6610, 6710, 7610, 7710 (1981-); 8000 (10/1969-1978); 9000 (1969-1978).

REPLACES

PTO Piston Rings



313283
\$10.50

Pistons rings for PTO clutch. For tractors with independent PTO 4000 (4-1968 to 1975); 4110, 4610, (1981 to -); single-speed 5000, 7000, (1965 to 1975); 2-speed 5000, 7000, (1965 to 1975); single- & 2-speed 5600, 5700, 6600, 6700, 7600, 7700, (1975 to 1981); 5610, 6610, 6710, 7610, 7710, (1981 to -); 8000, 9000 (1968 to 1978).

REPLACES

Cross & Bearing Assemblies



CBAN6K
\$9.36

Cross & bearing kit. Used on Ford equipment. (171333).

243250
\$11.63

Cross & bearing kit, drive shaft. For 907, 917.

CBA350
\$14.36

Cross & bearing kit. Two used on 605 and three used on 612 Harvester PTO drive shaft assembly. (24324) For 605 and 612 forage harvesters.

293351
\$9.36

Cross & bearing kit, front. Used on hydraulic pump drive shaft C5NNA932BA & EONNA932BA. For utility tractors 340, 445, 540, 545; industrial tractors 535, 4500.

6R
\$9.36

243250-IMP
\$11.63

Series 14N cross & bearing kit. 2-11/16" effective length, 1-1/8" bearing cup dia., type 2, needle bearing. (14R)

12R
\$9.36

Series 12N cross & bearing kit. 1-13/16" effective length, 1-1/16" bearing cup dia., type 1, needle bearing.

REPLACES

PTO Clutch Brake Band



E0NNB726AB
\$35.90

Brake band, for PTO drive clutch. For tractors 5000, 7000, (6-1973 to 1975); 5600, 5700, 6600, 6700, 7600, 7700, (1975 to 1981); 5110, 5610, 5910, 6410, 6610, 6710, 6810, 7610, 7710, (1981 to -). Replaces E0NNB726AA.

REPLACES

Over-Running Couplers



C660F
\$52.65

1-3/8" female to 1-3/8" male, 6 spline.

C670F
\$49.68

1-1/8" female to 1-3/8" male, 6 spline.

C680F
\$114.09

1-3/8" female to 1-1/8" male, 6 spline.

C690F
\$89.25

1-1/8" female to 1-1/8" male, 6 spline.

RP20-16
\$0.39

Roll pin, special, for over-running couplers 5/16" x 2".

REPLACES

PTO Spined Adaptor & Reducers

XB373HD
\$41.07

KWIK-D-TACH adaptor. Push pin type, heavy duty. 1-3/8" 21-spline female to 1-3/8" 6-spline male.

231082
\$12.57

Sleeve adaptor. Increases 1-1/8" to 1 3/8"; Tisco T363; 2" long.

T352
\$22.20

1-1/8" female 6-spline to 1-3/8" male 6-spline. 2-1/4" length.

T363
\$12.57

1-1/8" female 6-spline to 1-3/8" male 6-spline. 2" length. Replaces 231082.

- T353F** Extends and increases 1-1/8" to 1-3/8"; 5-3/8" long.
\$23.10
- R420** Extends and reduces 1-3/8" to 1-1/8"; 5" long.
\$40.14
- T318** 1-1/8" 6-spline female to 1-3/8" 6-spline male, adapts older 1-1/8" shaft. Increases PTO length only 1-1/8".
\$8.13

REPLACES

PTO Related Parts

- 9N715BC** Ball bearing, PTO front, with 1-1/8" & 1-3/8" shaft. For tractors 9N, 2N, NAA (to 1955).
\$5.99 
- 9N754** Snap ring, for bearing 9N715B. 2 used. For tractors 9N, 2N, NAA (to 1955).
\$1.14
- C5NN747A** PTO cover gasket, 1-1/8" & 1-3/8" PTO. For all models except Majors (1939-1964).
\$0.48 
- P516PTL** PTO Lock Pin, 5/16" dia., 2-5/8" usable length, round handle.
\$0.74 
- 310088** PTO cap, high tensile aluminum alloy. For all Ford models (use with TISCO conversion PTO shafts).
\$7.31 

REPLACES

Drive Shaft Yokes



- 14N220-21** Yoke, 1-3/8", 6 spline plain. For implement end on 907 series flail mower (220394).
\$31.49
- 149147** Yoke, 1-3/8", 6 spline quick detach. For tractor end of various drive shafts.
\$35.93